

Cylindrical Roller Bearings

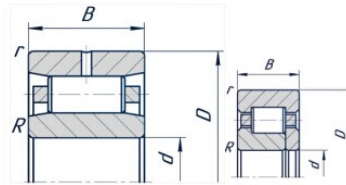

select	Inquiry	Bearing NO.		Boundary dimensions(mm)							Basic load ratings(kN)		Limiting speed(rpm)		Abutment and fillet dimensions(mm)					Weight (kg)	
		New	Old	d	D	B	r	1.2min	r ₃ □4m in	Fw	Ew	Cr	Cor	Grease	Oil	da min	db min	Da max	Db max	ra max	rb max
N220M	2220	100	180	34	2.1	2.1		160	190	260	3200	3800	114			166	2	2	3.45		
NJ220EM		100	180	34	2.1	2.1	119		190	260	3200	3800		114	169		2	2	3.9		
NF220M	12220	100	180	34	2.1	2.1		160	190	260	3200	3800	114			166	2	2	3.55		
NU220M	32220	100	180	34	2.1	2.1	120		190	260	3200	3800		114	169		2	2	5.2		
NJ220EM	42220	100	180	34	2.1	2.1	119		190	260	3200	3800		114	169		2	2	3.9		
NU2220M	32520	100	180	46	2.1	2.1	120		260	390	3200	3800		114	169		2	2	5.2		
NU320EM	32320EH	100	215	47	3	3	127.5		380	470	2400	3000		116	202		2.5	2.5	8.35		
N320EM	2320EH	100	215	47	3	3		191.5	380	470	2400	3000	116			197	2.5	2.5	9.67		
N2320M	2620	100	215	73	3	3		185.5	440	630	2400	3000	116			197	2.5	2.5	13.1		
NU2320M	32620	100	215	73	3	3	129.5		440	630	2400	3000		116	197		2.5	2.5	13.2		
NJ2320M	42620	100	215	73	3	3	129.5		440	630	2400	3000		116	197		2.5	2.5	13.5		
NF1021M	12121	105	160	26	2	1.1	119.5	145.5	120	176	4000	4800		114	150		2	1	1.93		
N1021M	2121	105	160	26	2	1.1		145.5	120	176	4000	4800	117			150	2	1	1.82		
N221M	2221	105	190	36	2.1	2.1		168.8	210	290	3000	3600	119			175	2	2	4.33		
NJ221M	42221	105	190	36	2.1	2.1	126.8		210	290	3000	3600		121	179		2	2	4.34		
N321EM	2321EH	105	225	49	3	3		201	420	550	2200	2800	121			203	2.5	2.5	10.5		
NU321EM	32321EH	105	225	49	3	3	133		420	550	2200	2800		121	212		2.5	2.5	10.6		
N421M	2421	105	260	60	4	4		220.5	550	700	2200	2800	121			224	3	3	17.2		
N1022M	2122	110	170	28	2	1.1		155	148	203	3800	4500	122			160			2.31		
NU1022M	32122	110	170	28	2	1.1	125		148	203	3800	4500		119	157		2	1	2.32		
NJ1022M	42122	110	170	28	2	1.1	125		148	203	3800	4500		119	157		2	1	2.39		
N222M	2222	110	200	38	2.1	2.1		178.5	255	340	2800	3400	124			185	2	2	5.02		
NU222M	32222	110	200	38	2.1	2.1	132.5		255	340	2800	3400		124	185		2	2	5.05		
NJ222M	42222	110	200	38	2.1	2.1	132.5		255	340	2800	3400		124	185		2	2	5.1		
NU2222EC	32522	110	200	53			132		380	520	2800	3400		124	185		2	2	7.73		
N322EM	2322EH	110	240	50	3	3		211	430	540	2000	2600	126			227	2.5	2.5	11.4		
NU322M	32322	110	240	50	3	3	143	207	400	525	2000	2600		126	222		2.5	2.5	11.6		
NJ322M	42322	110	240	50	3	3	143	207	400	525	2000	2600		126	222		2.5	2.5	11.8		
NU2322EM	32622EH	110	240	80	3	3	143		620	800	2000	2600		126	222		2.5	2.5	18.3		
N422M	2422	110	280	65	4	4		235	580	735	2000	2600	130			252	3	3	21.8		