

CS Series

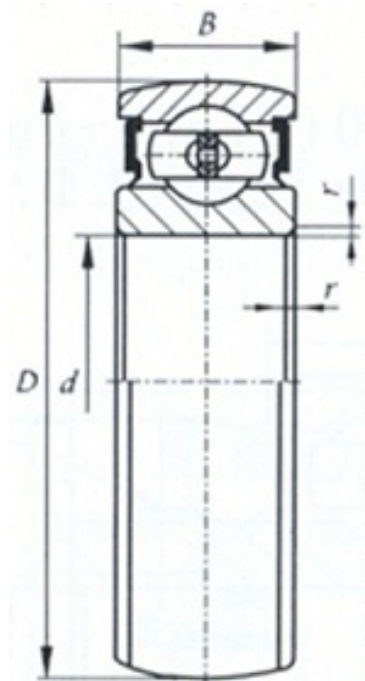

select	Inquiry	Bearing Designation	Dimension [mm]					Basic load ratings (kN)	
			d	D	C	B	r min	Cr	Cor
	CS201	12	32	10	10	0.6	680	300	
	CS202	15	35	11	11	0.6	760	370	
	CS203	17	40	12	12	0.6	960	480	
	CS204	20	47	14	14	1	1280	660	
	CS205	25	52	15	15	1	1400	790	
	CS305	25	62	17	17	1.1	2250	1150	
	CS206	30	62	16	16	1	1950	1150	
	CS306	30	72	19	19	1.1	2700	1500	
	CS207	35	72	17	17	1.1	2550	1500	
	CS307	35	80	21	21	1.5	3350	1920	
	CS208	40	80	18	18	1.1	2950	1800	
	CS308	40	90	23	23	1.5	4080	2400	
	CS209	45	85	19	19	1.1	3150	2080	
	CS309	45	100	25	25	1.5	5280	3150	
	CS210	50	90	20	20	1.1	3500	2320	
	CS310	50	110	27	27	2	6180	3800	