

## 62300 Series

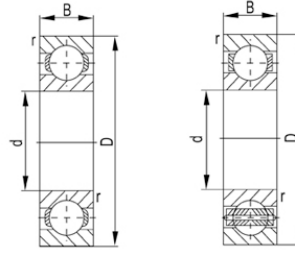

**select Inquiry Bearing No.    Boundary dimensions [mm]    Basic load ratings(kN)    Mass**

			<b>d</b>	<b>D</b>	<b>B</b>	<b>rs min</b>	<b>Dynamic(Cr)</b>	<b>Static(Cor)</b>	<b>Kg</b>
62301	12	37	17	-	-	-	-	-	
62302	15	42	17	-	-	-	-	-	
62303	17	47	19	-	-	-	-	-	
62304	20	52	21	-	-	-	-	-	
62305	25	62	24	-	-	-	-	-	
62306	30	72	27	-	-	-	-	-	
62307	35	80	31	-	-	-	-	-	
62308	40	90	33	-	-	-	-	-	
62309	45	100	36	-	-	-	-	-	
62310	50	110	40	-	-	-	-	-	